



## Elder Lane + Centennial Beach Project Timeline

TIMELANE IS BASED ON WHAT WE KNOW CURRENTLY +  
THE APPROVAL PROCESS AS OF MARCH 2023

### Elder Lane Park + Beach | Phase One

- Plan review + design | *1ST OR 2ND QUARTER 2023*
- Review + presentation for Park Board approval | *2ND QUARTER 2023*
- Permit review + submittal | *2ND QUARTER 2023*
- Permit review process | *2ND QUARTER 2023 (CAN BE A 6 - 18 MONTH PROCESS)*
- Final plan + review process | *3RD QUARTER 2023 (ANTICIPATED)*
- Bid review + presentation for Park Board approval | *3RD OR 4TH QUARTER 2023*
- Construction | *4TH QUARTER 2023, WILL RUN THROUGH 3RD QUARTER 2024 (ANTICIPATED)*

### Centennial Park + Beach | Phase One

- Plan review + design | *2ND QUARTER 2023*
- Review + presentation for Park Board approval | *2ND QUARTER 2023*
- Permit review + submittal | *2ND OR 3RD QUARTER 2023*
- Permit review process | *2ND OR 3RD QUARTER 2023 (CAN BE A 6 - 18 MONTH PROCESS)*
- Final plan + review process | *3RD QUARTER 2023 (ANTICIPATED)*
- Bid review + presentation for Park Board approval | *3RD OR 4TH QUARTER 2023*
- Construction | *4TH QUARTER 2023, WILL RUN THROUGH 3RD QUARTER 2024 (ANTICIPATED)*

### Centennial Park + Beach | Phase Two

- Contingent upon funding

### Elder Lane + Centennial Beach | Phase Three Beach Unification

- Contingent upon acquisition of 261 Sheridan Road + funding



# Elder + Centennial | Phase One

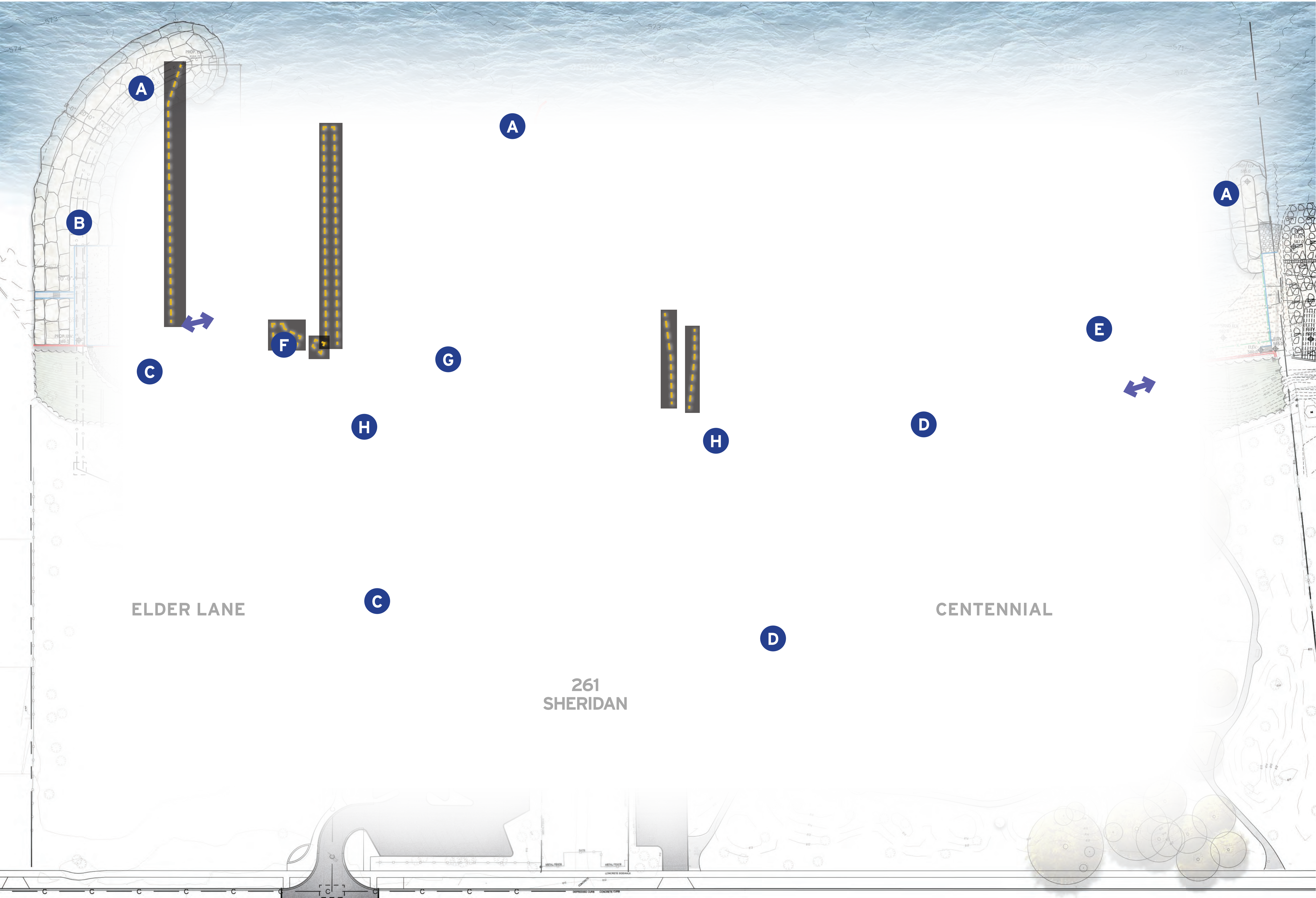

**LEGEND**

	PROPOSED BLUFF RESTORATION
	ACCESS TO BEACH
	SHEET PILE (PROPOSED)
	SHEET PILE (EXISTING)
	ITEM TO BE REMOVED
	STONE BREAKWATER SYSTEM SHORELINE PROTECTION
	PROPOSED STORMWATER REROUTE
	CONSTRUCTION ACCESS ROUTE (FUTURE PEDESTRIAN ONLY)
	ACCESSIBLE PEDESTRIAN PATH TO BEACH
	PROPOSED CENTENNIAL DOG BEACH
	BOARDWALK AND BEACH ACCESS
	PAD FOR FOOD TRUCKS AND SEATING
	BLUFF RESTORATION



# Elder + Centennial | Phase Two

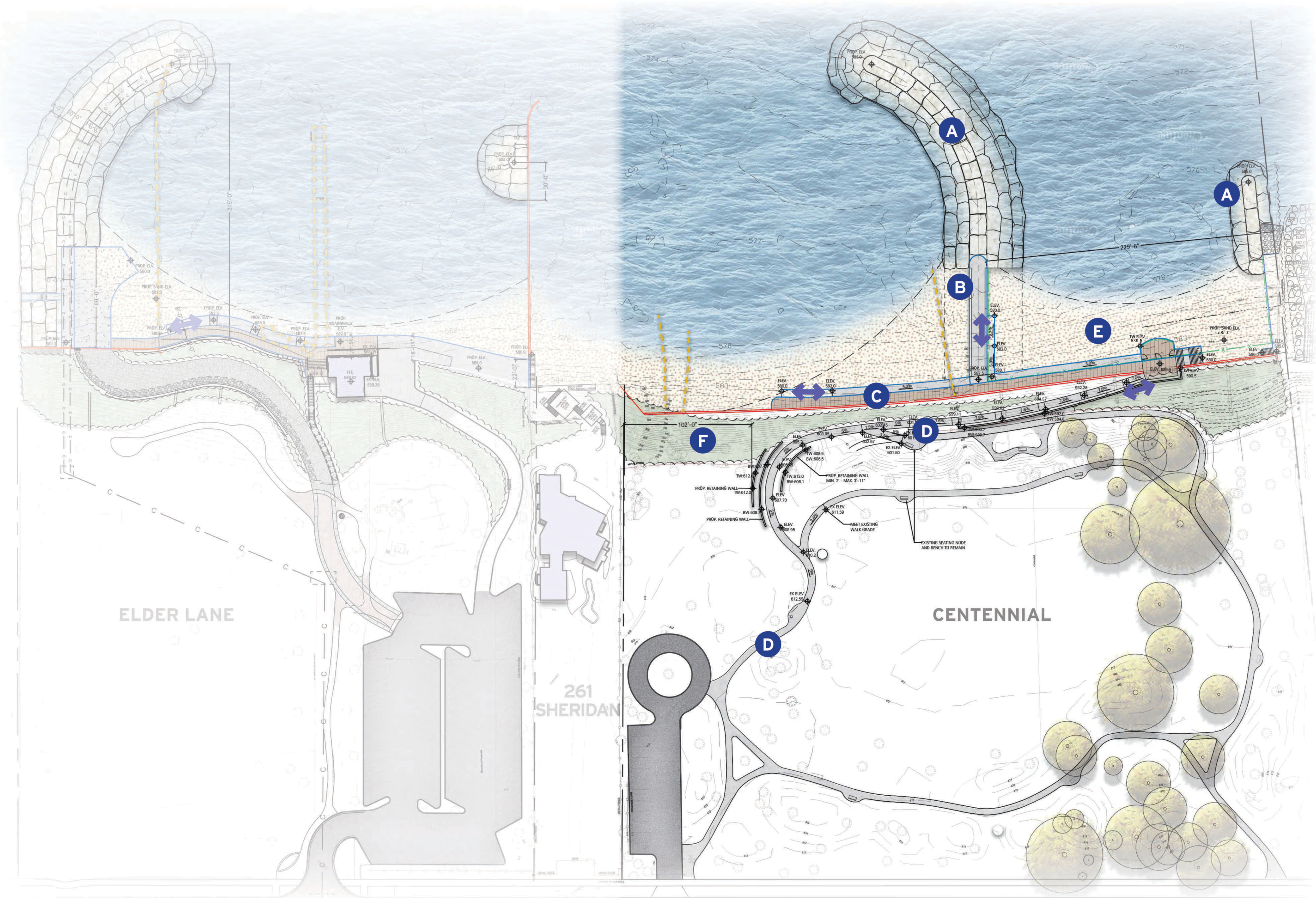

LEGEND

- PROPOSED BLUFF RESTORATION
- ACCESS TO BEACH
- SHEET PILE (PROPOSED)
- SHEET PILE (EXISTING)
- ITEM TO BE REMOVED
- A STONE BREAKWATER SYSTEM SHORELINE PROTECTION
- B ACCESSIBLE VIEWING PIER WITH BENCH SEATING
- C ACCESSIBLE BOARDWALK + BEACH ACCESS
- D ACCESSIBLE PEDESTRIAN PATH TO BEACH
- E PROPOSED CENTENNIAL DOG BEACH
- F BLUFF RESTORATION

SCALE: 1"=40'  
0 20' 40' 80' NORTH



# Elder + Centennial | Phase 3 Full Vision

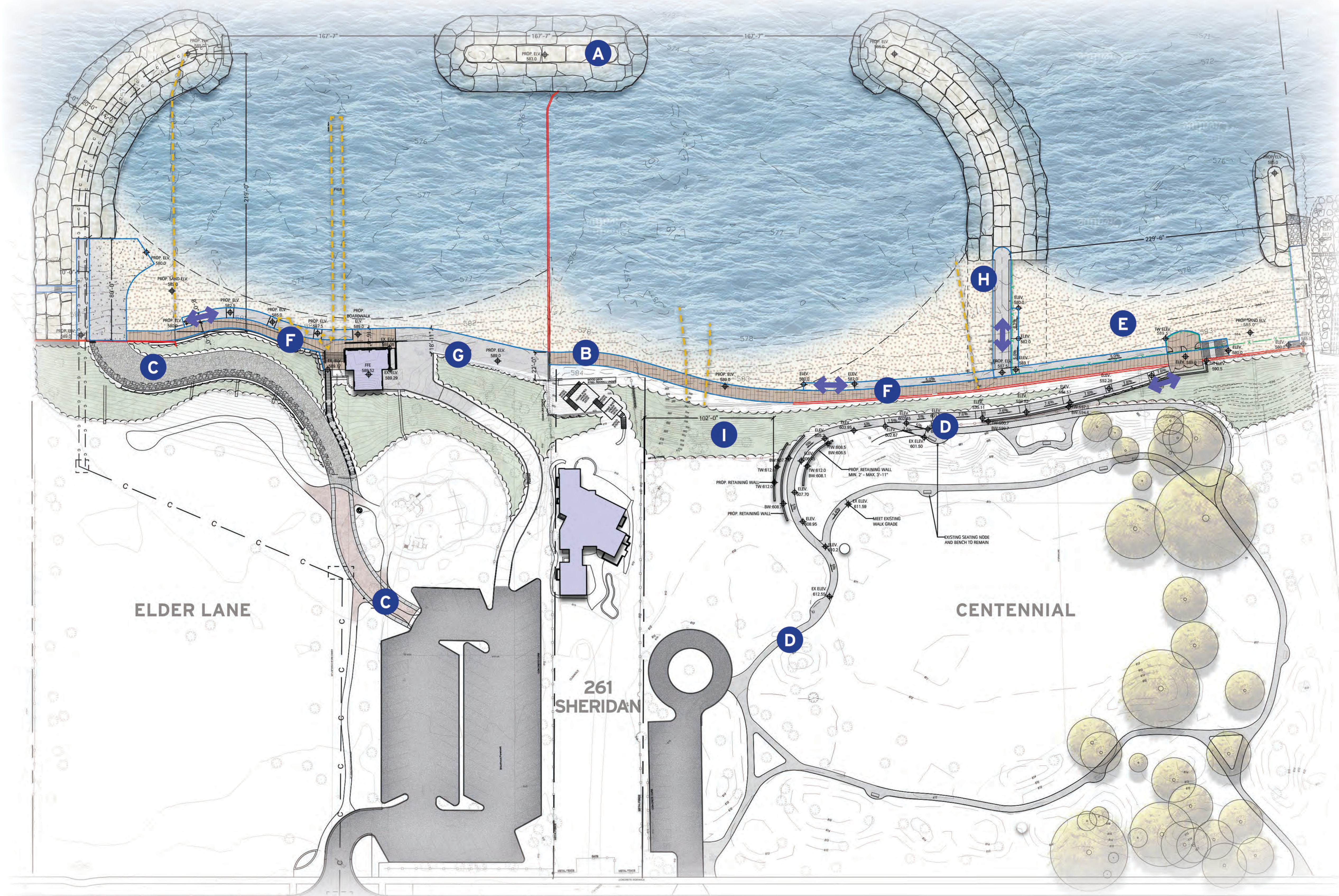

LEGEND

- PROPOSED BLUFF RESTORATION
- ACCESS TO BEACH
- SHEET PILE (PROPOSED)
- SHEET PILE (EXISTING)
- ITEM TO BE REMOVED

- A STONE BREAKWATER SYSTEM SHORELINE PROTECTION
- B BOARDWALK CONNECTION
- C CONSTRUCTION ACCESS ROUTE (FUTURE PEDESTRIAN ONLY)
- D ACCESSIBLE PEDESTRIAN PATH TO BEACH
- E PROPOSED CENTENNIAL DOG BEACH
- F ACCESSIBLE BOARDWALK + BEACH ACCESS
- G PAD FOR FOOD TRUCKS AND SEATING
- H ACCESSIBLE VIEWING PIER WITH BENCH SEATING
- I BLUFF RESTORATION



# Lloyd Beach v. Elder & Centennial | Scaled Comparison

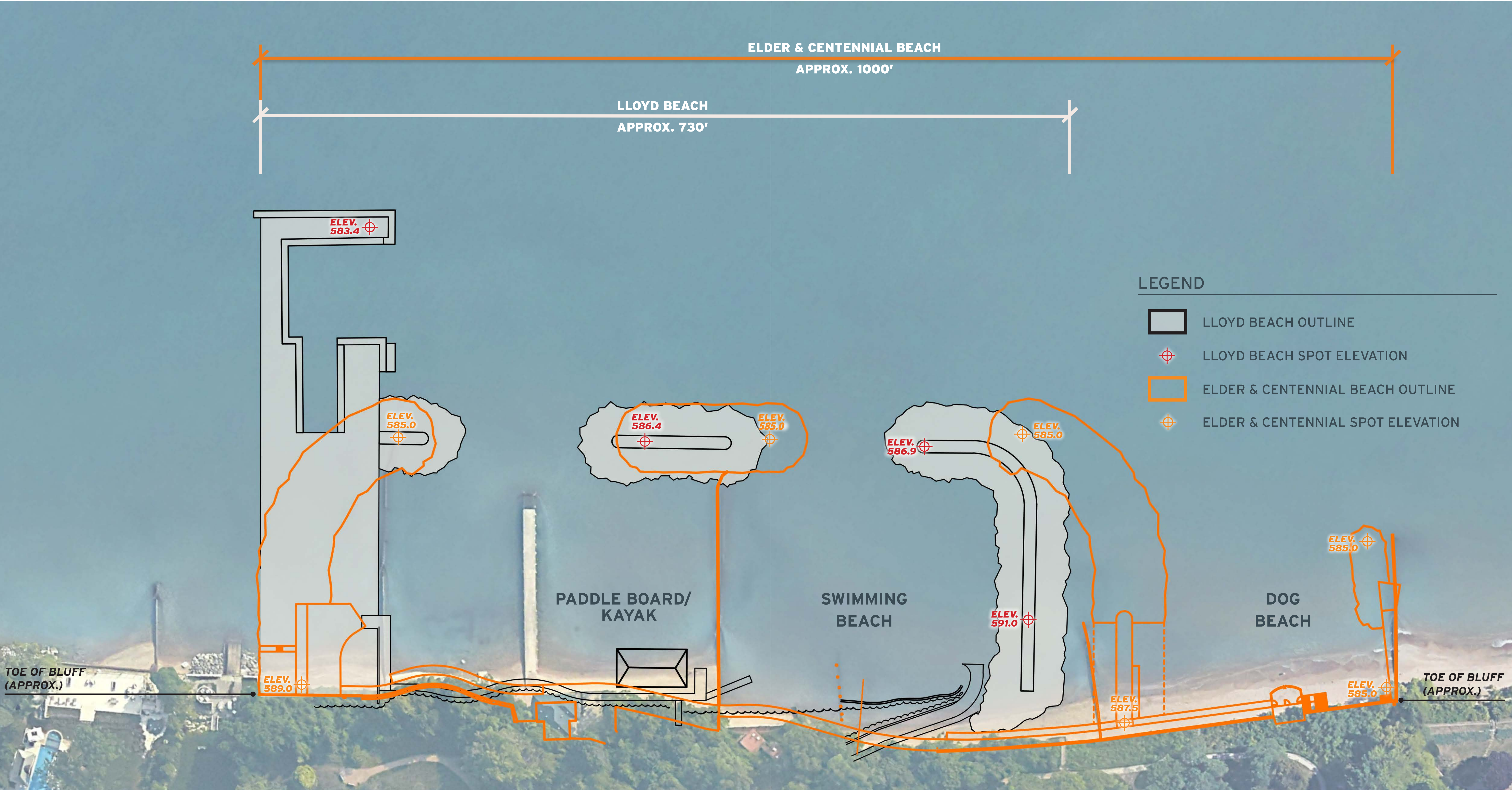

Please note: this graphic does not currently take into consideration the property exchange agreement.

SCALED VISUAL COMPARISON



# Elder + Centennial | Drone Imagery

ELDER | CENTENNIAL  
BEACH FEASIBILITY STUDY



## Centennial



## Overall Aerial

## Elder Lane





# Elder | Existing Conditions

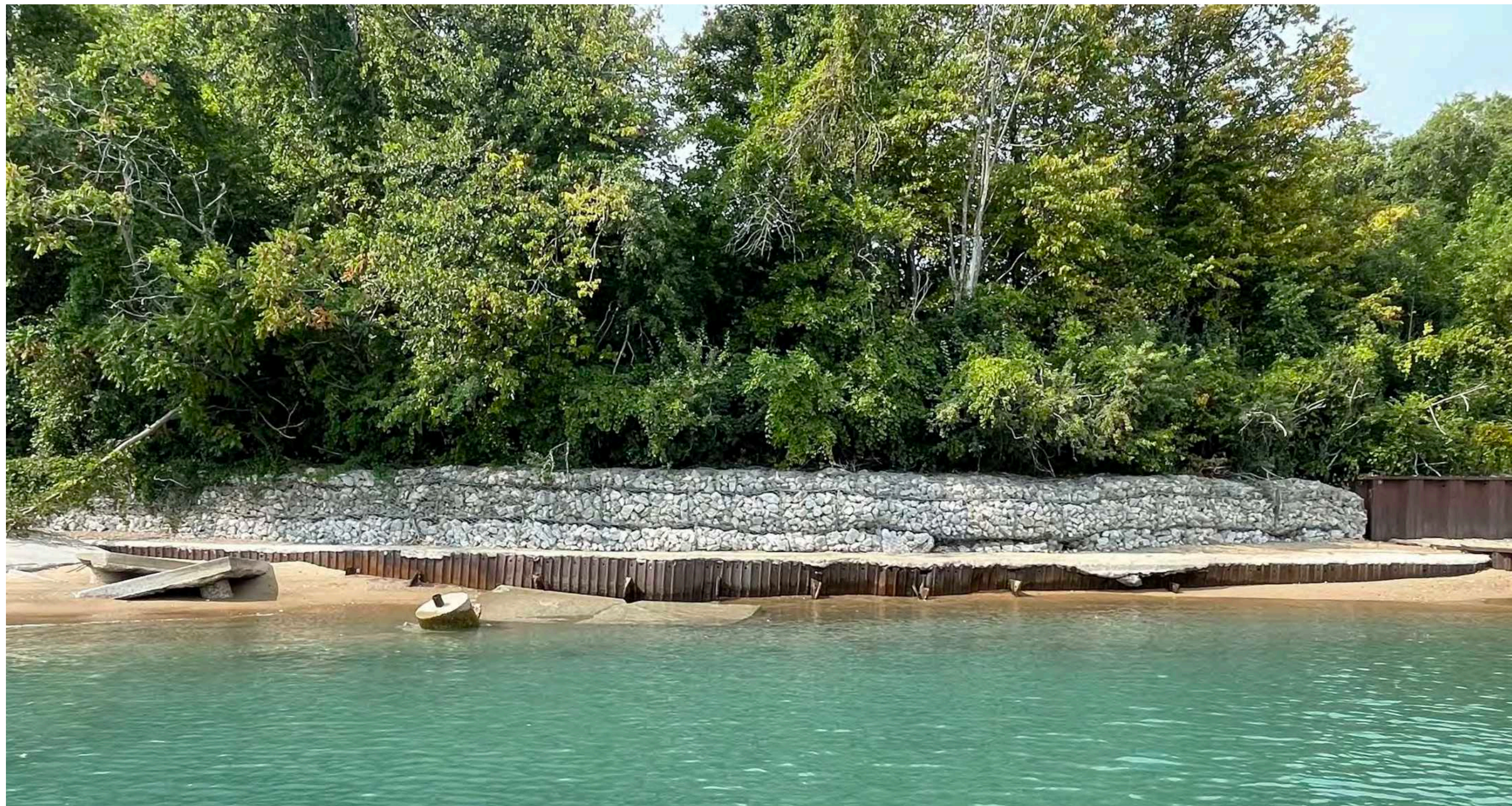

ELDER LANE | SHORELINE  
SEPTEMBER 2021



ELDER LANE | FAILING GABION BLANKETS  
OCTOBER 2020



ELDER LANE | FAILING GABION BLANKETS  
OCTOBER 2020



ELDER LANE | FAILING PIER  
SEPTEMBER 2020



# Lloyd Beach v. Elder + Centennial | Scaled Comparison

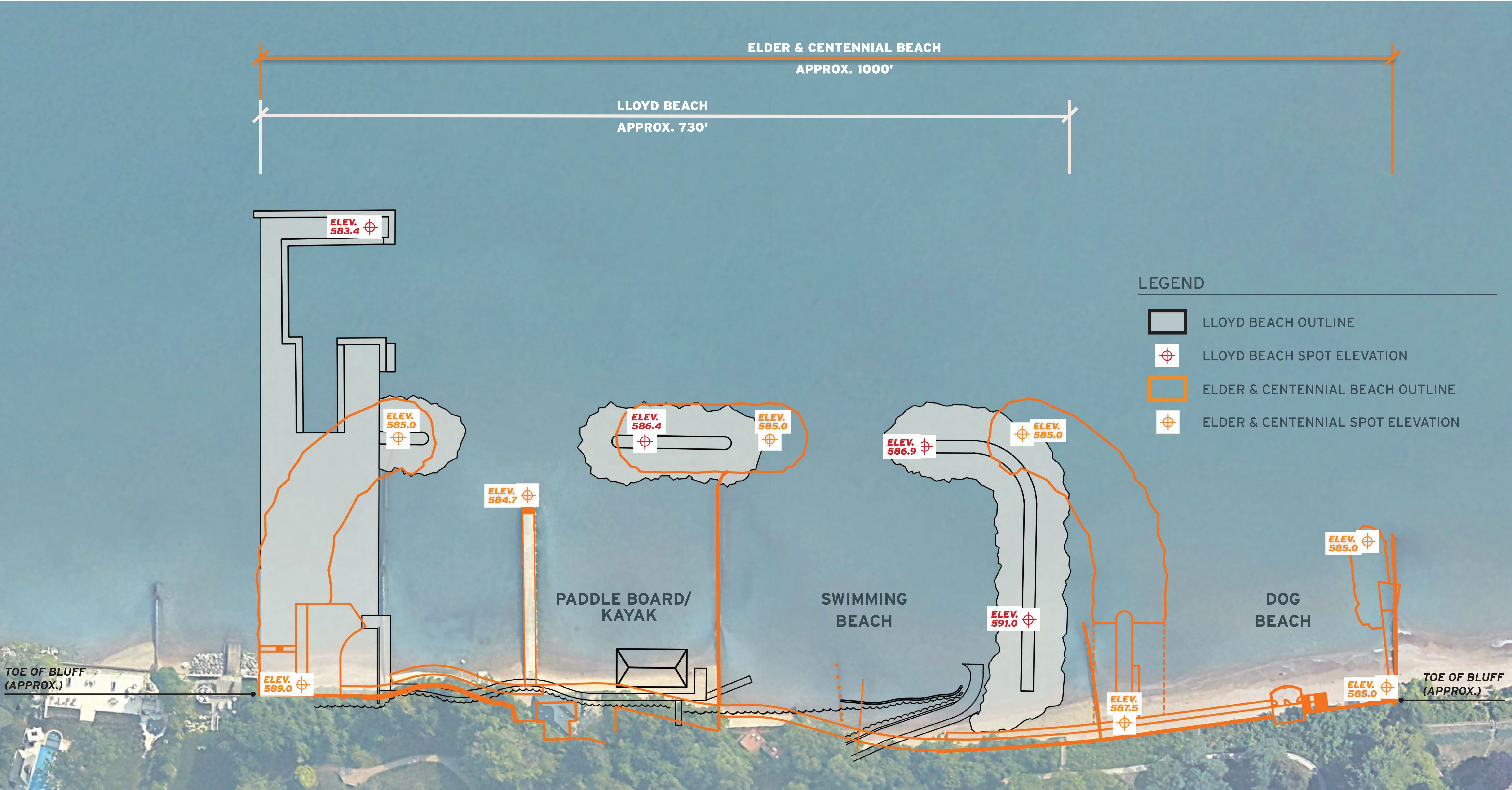

Please note: this graphic does not currently take into consideration the property exchange agreement.

## SCALED VISUAL COMPARISON

SCALE: 1"=40'  
0 20' 40' 80' NORTH

DRAFT PLAN 3/18/2023



# Lloyd | Previous Conditions

ELDER | CENTENNIAL  
BEACH FEASIBILITY STUDY

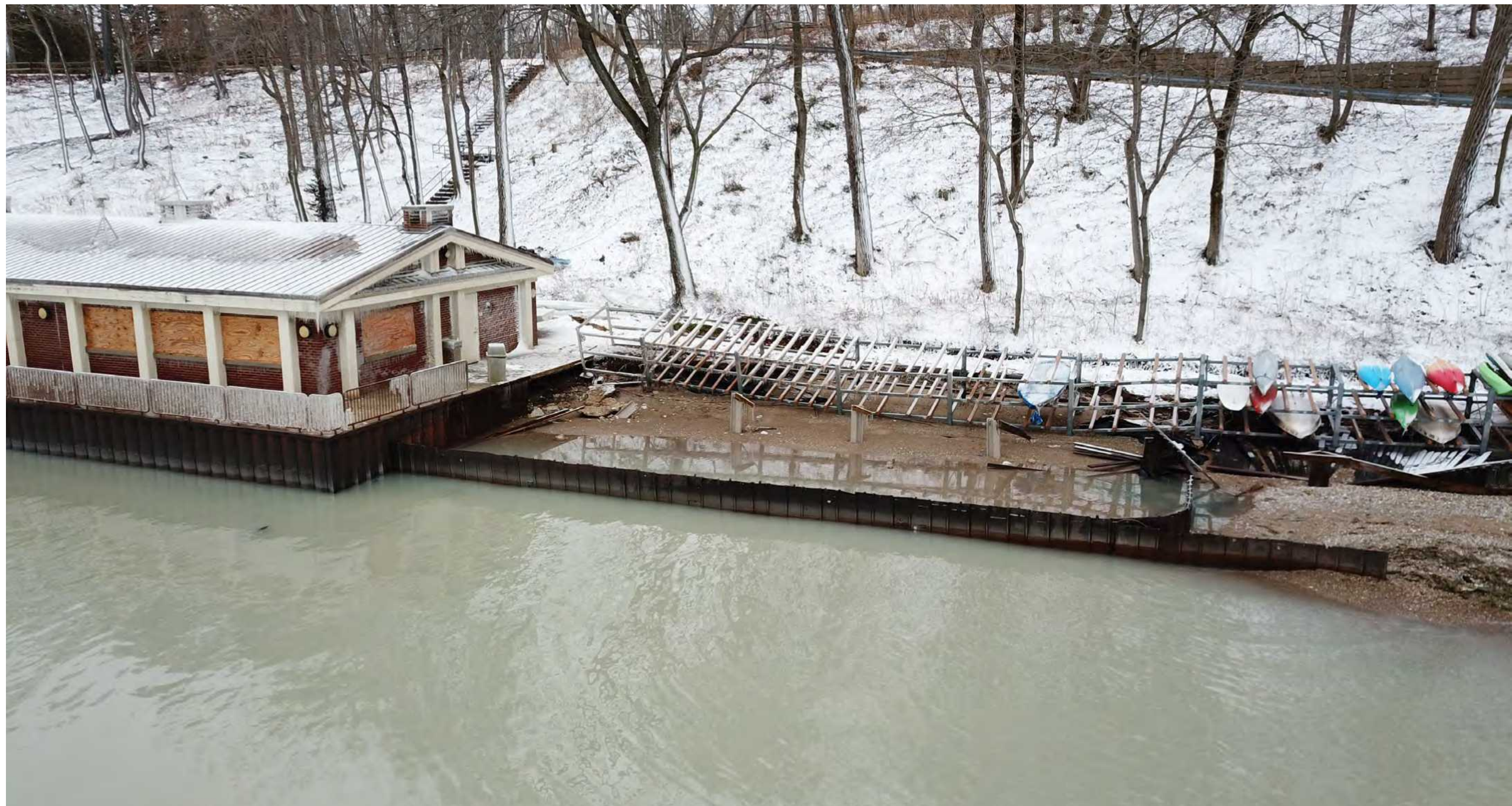

LLOYD | STEEL ELEVATION 584.4  
OCTOBER 2019



LLOYD | STEEL ELEVATION 583.3  
OCTOBER 2019



LLOYD | HEIGHT ELEVATION 586.5  
OCTOBER 2019



LLOYD | HEIGHT ELEVATION 586.5  
OCTOBER 2019



# Elder | Phase One Stomwater Relocated



DRAFT

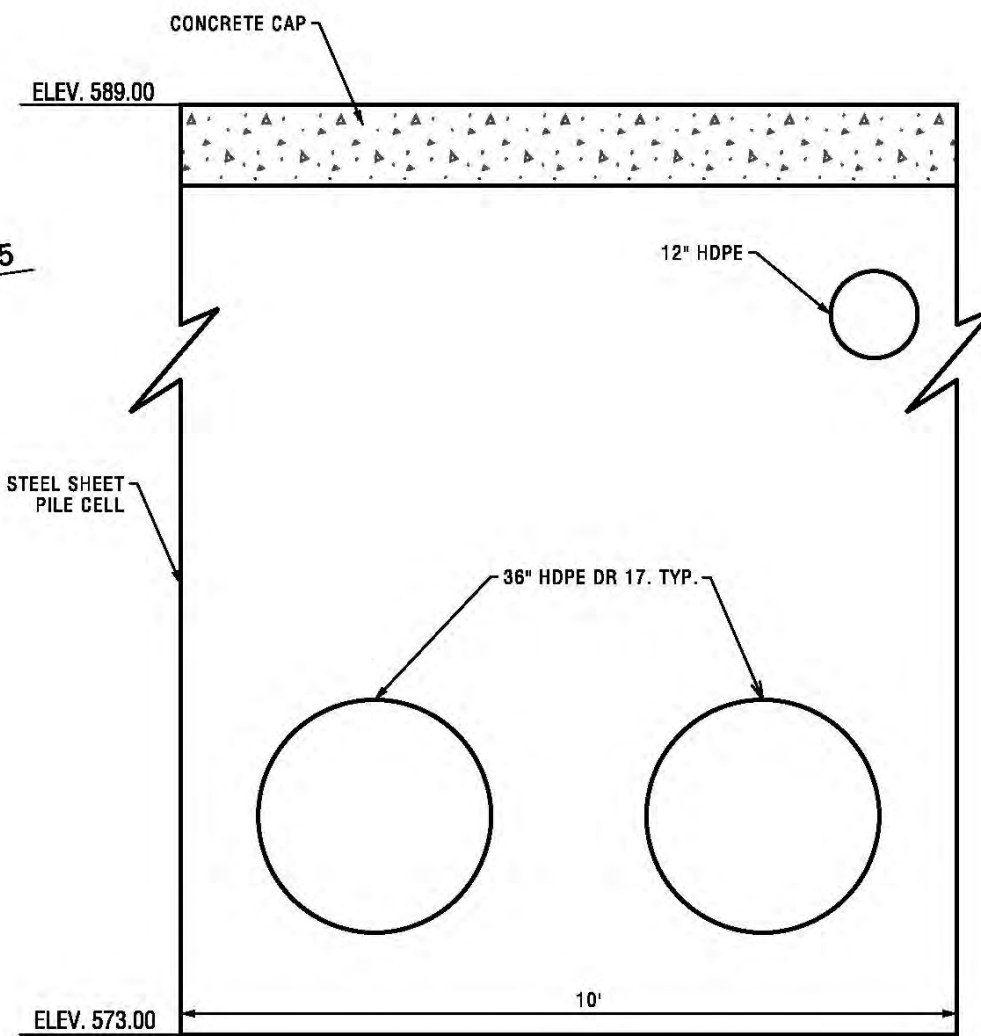
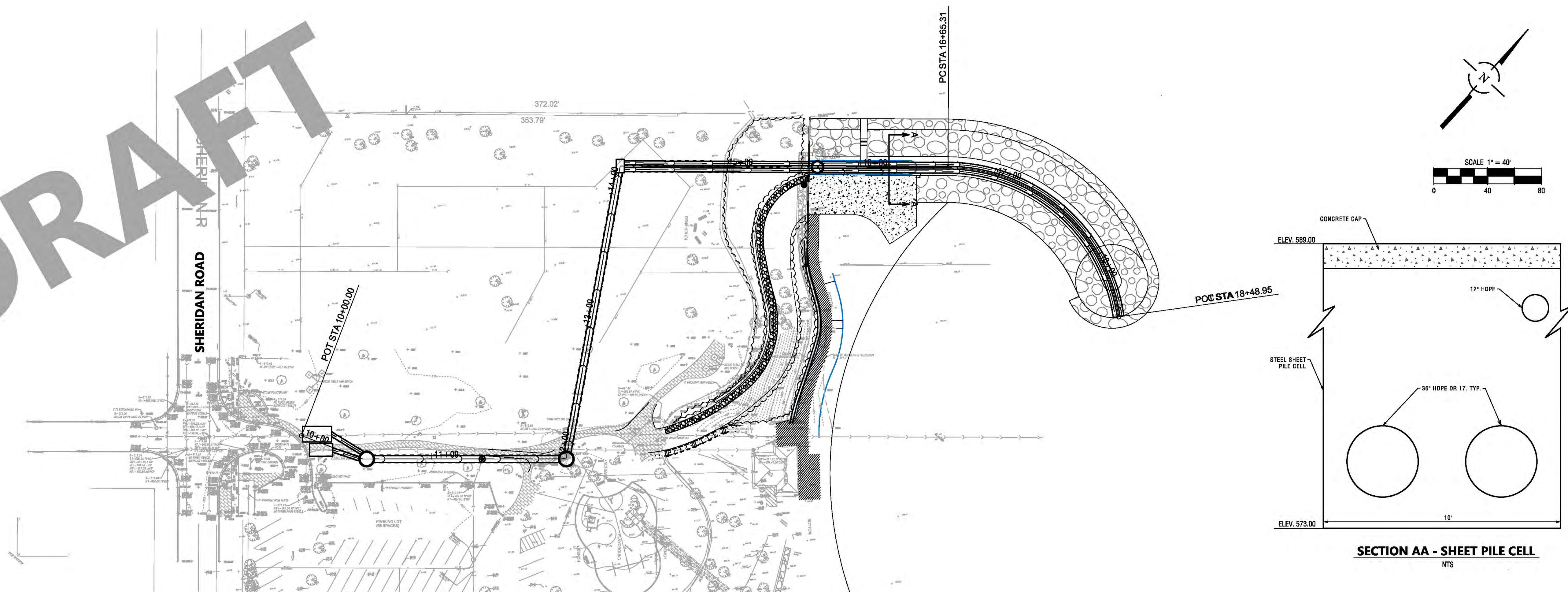

SECTION AA - SHEET PILE CELL  
NTS

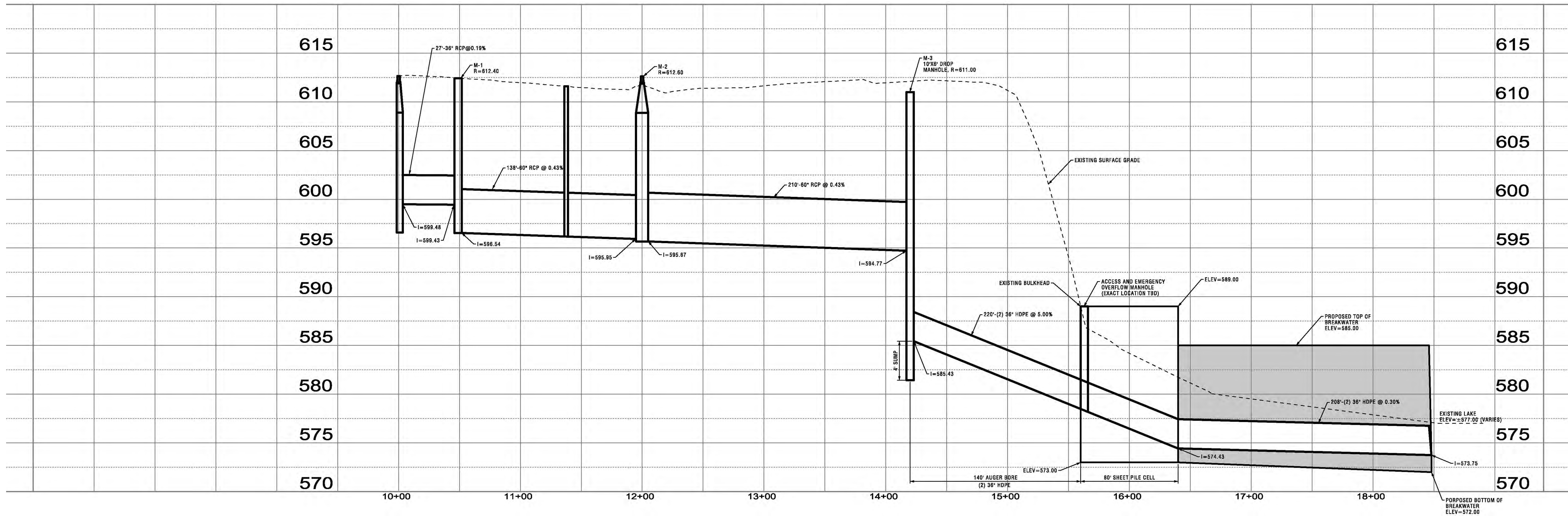



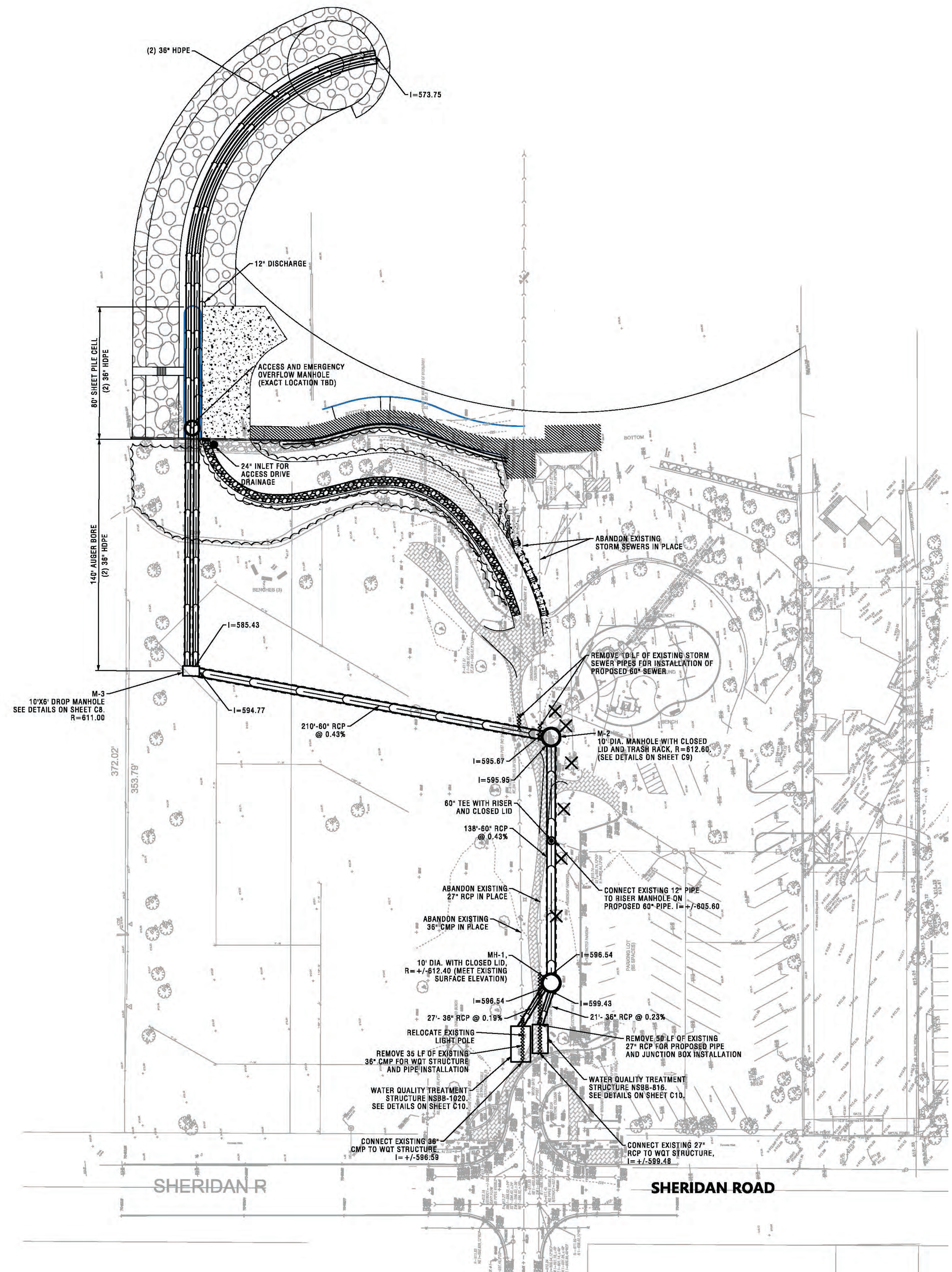



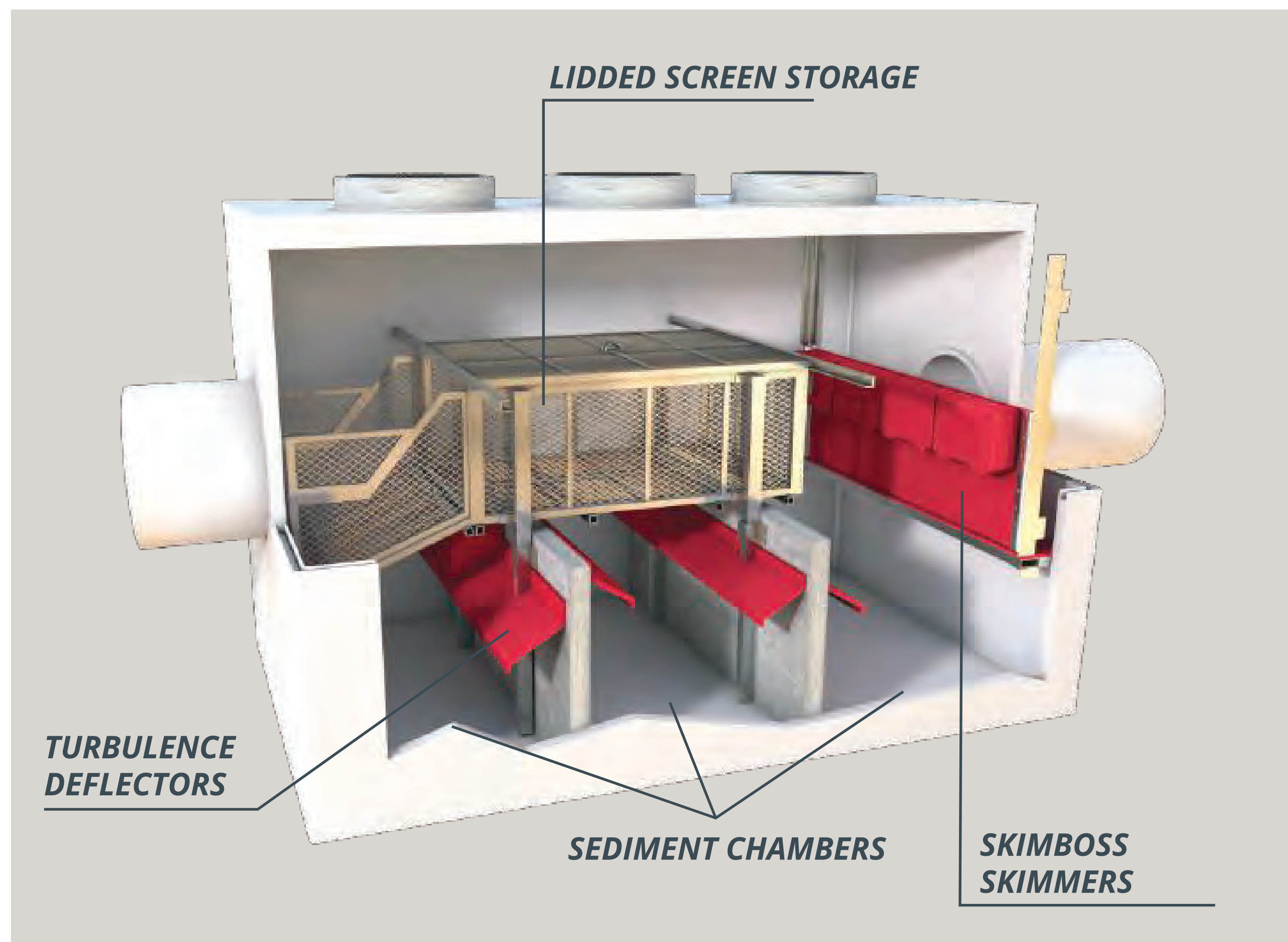

## NUTRIENT SEPARATING BAFFLE BOXES

- BOTH BOXES ARE MULTI-STAGED SELF CONTAINED TREATMENT SYSTEMS
- EACH SUBSEQUENT COMPONENT WITHIN THE SYSTEM PROTECTS PRIOR STAGES FROM CLOGGING ISSUES OR FAILURES
- THESE STAGES INCLUDE FILTRATION, HYDRODYNAMIC SEPARATION AND HYDROCARBON ABSORPTION
- REMOVAL RATES ARE 20% NITROGEN, 19% PHOSPHOROUS, 90% TSS
- THE KEY REMOVAL RATE IS SEDIMENT, AS SEDIMENT IS KNOWN TO "CARRY" OTHER POLLUTANTS FOR A RIDE
- REMOVAL OF THE VEHICLE IN THIS CASE IS ESSENTIAL TO POLLUTANT REMOVAL IN STORMWATER RUNOFF
- THESE UNITS CAPTURE THOUSANDS OF POUNDS OF DEBRIS, SEDIMENT, AND NUTRIENTS
- THE PREVIOUS OUTFALL CONFIGURATION DID NOT HAVE WATER QUALITY TREATMENT

