

The following plan concept was submitted by Chuck Dowding.

Elder Now Plan to produce swimmable beach without foreclosing options

Observations

I As a first step avoid use of stone breakwater by relying on the bluff stabilization devices now in place which withstood the last high lake level. With lake at its average level (580) there is less urgency than at Lloyd.

II Some/many feel that Lloyd has too much sand and the elevation 591 or even the proposed Elder 589, 300 foot long breakwater produce a 11 or 9 ft wall at the water's edge when at the average (and present) lake level of 580

- Leave in place sheet pile groin at boundary between Elder/261 (elevation ~ 583) at southern end of 300 feet on drawing to right
 - Preserves view south at average lake level of 580
 - Allows for modest addition of sand to enlarge Elder beach if necessary
 - Can be removed at later date if necessary
- Build pollution reduction devices for Village storm sewer outfall already designed by Burke
- Revisit outfall discharge design; Why diffuser?
- Replace present design of two, 3 ft diameter storm water pipes with one 4 ft diameter pipe. This 4 footer provides 14% additional capacity compared to the 3 ft and 2.25 ft Village pipes coming to Elder.
- In surf zone, encase outfall pipe in sheet pile protection with maximum height of sheet piles equal to present groin height of 583. See drawing on right
- Beyond surf zone bury pipe in clay trench
 - 200 ft out as presently planned or
 - 350 ft to extend to deeper water for greater dilution and long shore drift flow
- Demolish pier housing present outfall pipe in middle of beach
- Build ramp in such a manner to take advantage of the new north sheet pile groin that encases/protects the outfall pipe.
- Now have some 400 ft beach to repurpose according to new post Lloyd use patterns
- Add beach sand if necessary
- Go swimming
- Continue negotiating with Ishbia
- Add stone breakwater if necessary

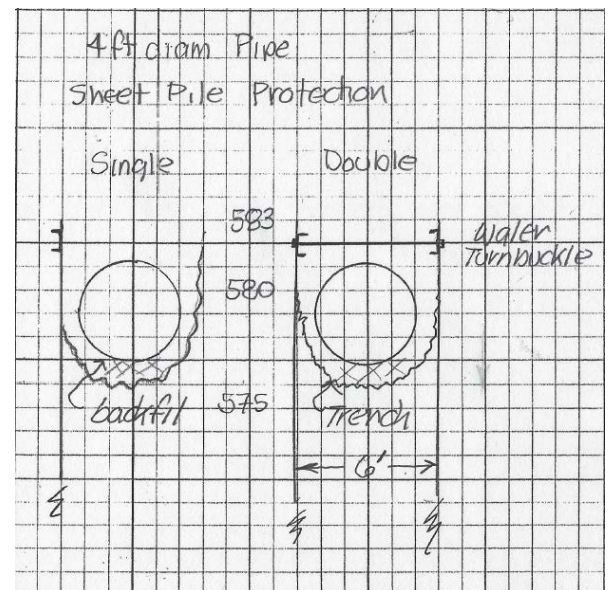

Landfills masquerading as planter pockets to enable vegetation barriers

I appreciate that the Winnetka Park District is trying to increase beach access by rejuvenating Elder-Centennial parks. Unfortunately by including large landfills (mischaracterized as planter pockets), the WPD is inadvertently decreasing beach access along 64 miles of Illinois beaches for many more people for a very long time. If IDNR accepts the landfills shown below, all riparian land owners along 64 miles of Illinois Lake Michigan beach will be able to employ vegetation to deny access to public beach. Rosa Rugosa, a dense thorny rose bush shown below, will physically block access. In addition each riparian land owner will be given the ability to fill in approximately some 6500 ft sq (~ 1/6 acre) of Lake Michigan and probably pay no taxes on that new land. The illustration below compares two Centennial landfills associated with the July workshop plan with the foot print of my house.

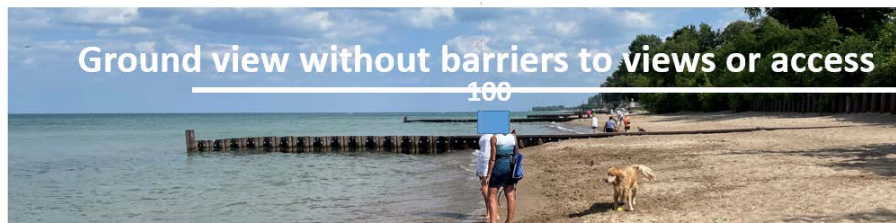
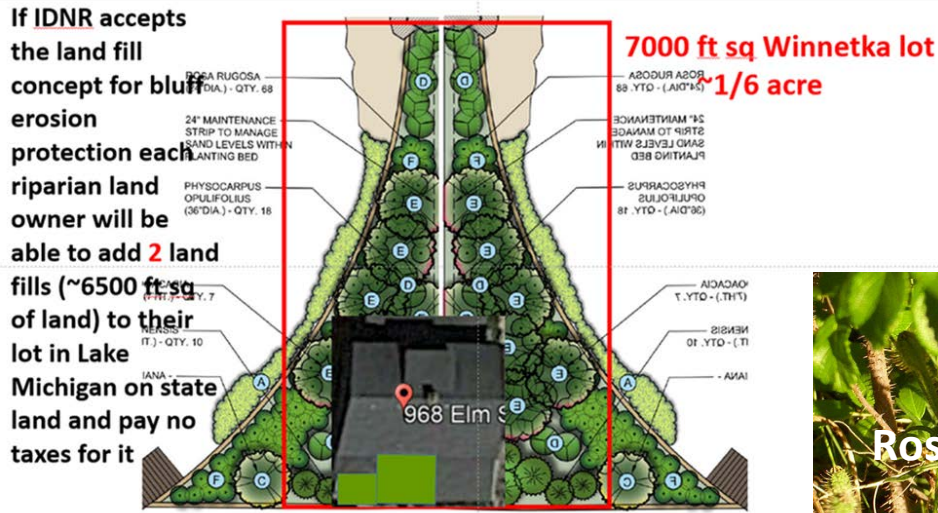

No other bluff erosion protection structure in Illinois has vertical planter boxes on beach or fence on top of erosion protection